

Late FRANCIS PARVIN
now HENRY ROUSE.

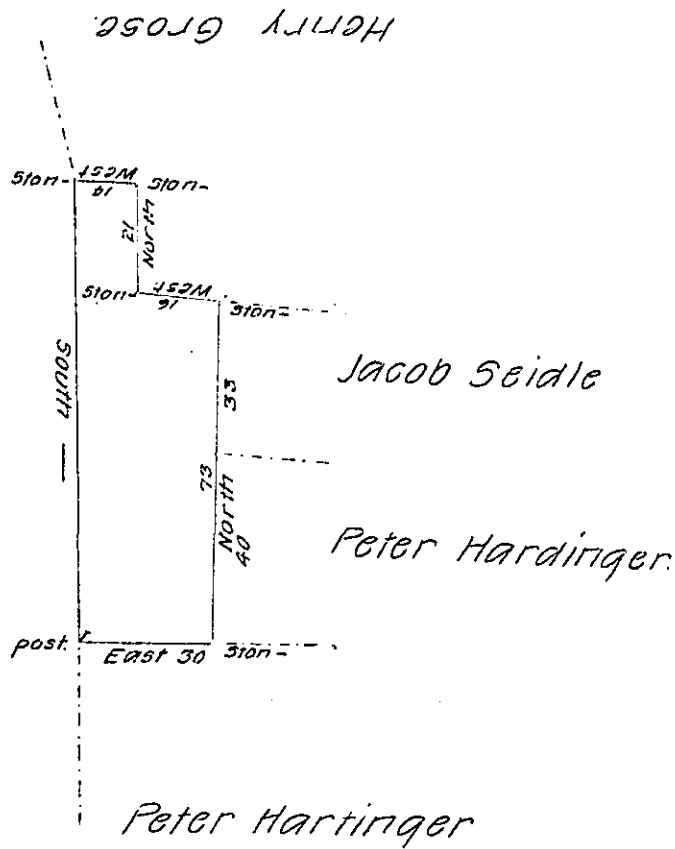

Nathaniel Morgan

By virtue of an Application No. 2908 and dated twenty seventh day of October 1767 and survey'd. Jun- the 9th day 1792 for Martin Rouse the above discribed tract of land situate in Windsor township Berks County. Containing fourteen acres and 103 perches and the allowance of 6 P. Cent.

Henry Vander glie -

To Daniel Brodhead Esq^r
Surveyor General

IN TESTIMONY that the above is a copy of the original remaining on file in the Department of Internal Affairs of Pennsylvania, made conformably to an Act of Assembly approved the 16th day of February, 1833, I have hereunto set my Hand and caused the Seal of said Department to be affixed at Harrisburg, this seventh day of March 1907.

Joseph P. Linn
Secretary of Internal Affairs.